

Medium: Air, Water, Alcohol, Soft drink, Oil
 Temperature: N-NBR: -5°C~80°C
 V- VITON: -10°C~120°C
 P-PTFE: -20°C~180°C
 Pressure: 0.0Mpa~1.6Mpa
 Port Size: 1/2", 3/4", 1", 1-1/4", 1-1/2", 1-3/4", 2", 2-1/4", 2-1/2", 3", 3-1/2", 4"
 Port Thread: Clamps
 Orifice(mm): ø19, ø25, ø32, ø38, ø45, ø51, ø57, ø63, ø76, ø89, ø102
 Voltage: DC-12V, 24V, 36V
 AC-24V, 120V, 240V/60Hz; 110V, 220V/50Hz
 Tolerance: ±10%
 Coils: Y32B, 40VA(AC), 18W(DC), IP65, 100%ED
 Y42B, 50VA(AC), 20W(DC), IP65, 100%ED
 S51B, 30VA(AC), 24W(DC), IP65, 100%ED
 SD01B, 28VA(AC), 36W(DC), IP65, 100%ED
 EX1620, 20VA(AC), 16W(DC), IP65, 100%ED
 Material: Body - stainless steel 304, 316, 316L
 Seal - NBR, VITON, PTFE
 Armature Tube - Stainless Steel 304
 Plunger - Stainless Steel 430F
 Stop - SS 403F
 Springs - SS 304
 Shading Rings - Stainless Steel 304



HK0018
(Normal Temperature)



HK0018A
(High Temperature)

Determine Valve Body Code

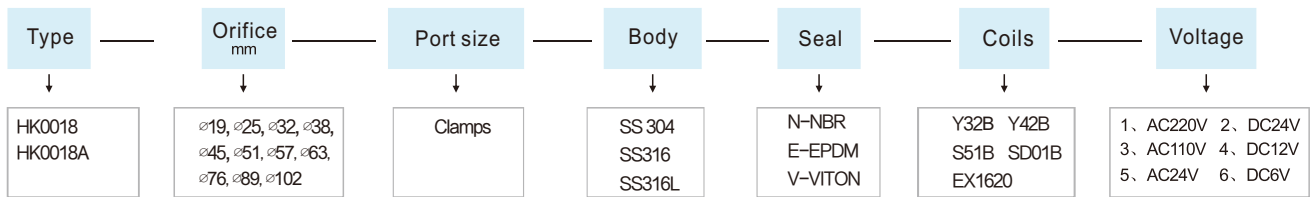

Outline Size Drawing

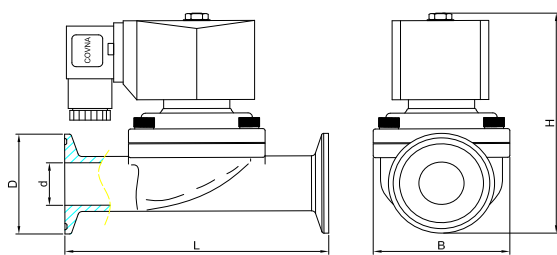

HK0018 (Normal Temperature)

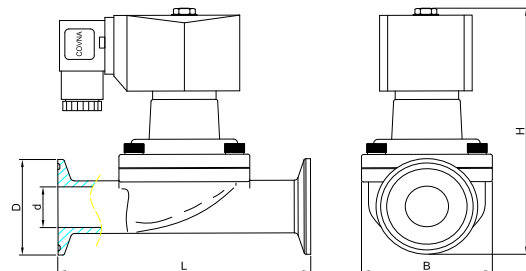

HK0018A (High Temperature)

Size	G	Cv	d	D	B	L (Normal)	H (Normal)	L (High)	H (High)
ø19	1/2"	4.8	15	50.5	50	95	125	115	145
ø25	3/4"	7.5	20	50.5	60	100	128	125	150
ø32	1"	12	25	50.5	75	140	138	130	168
ø38	1 1/4"	24	32	50.5	100	158	155	150	180
ø45	1 1/2"	29	40	64.0	105	160	175	160	200
ø57	2"	48	50	77.5	130	195	180	200	210